

Section J-J

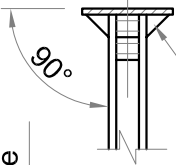

balsa fillet

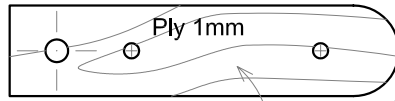

Drill holes to fit your screws.

WP 3mm, 2req.

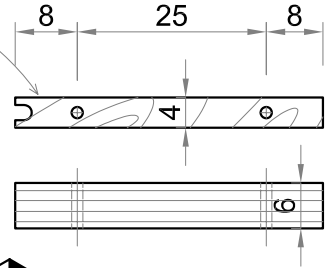

Note: glue elements on one sheet, sand wedge cross section, and the cover opposite side

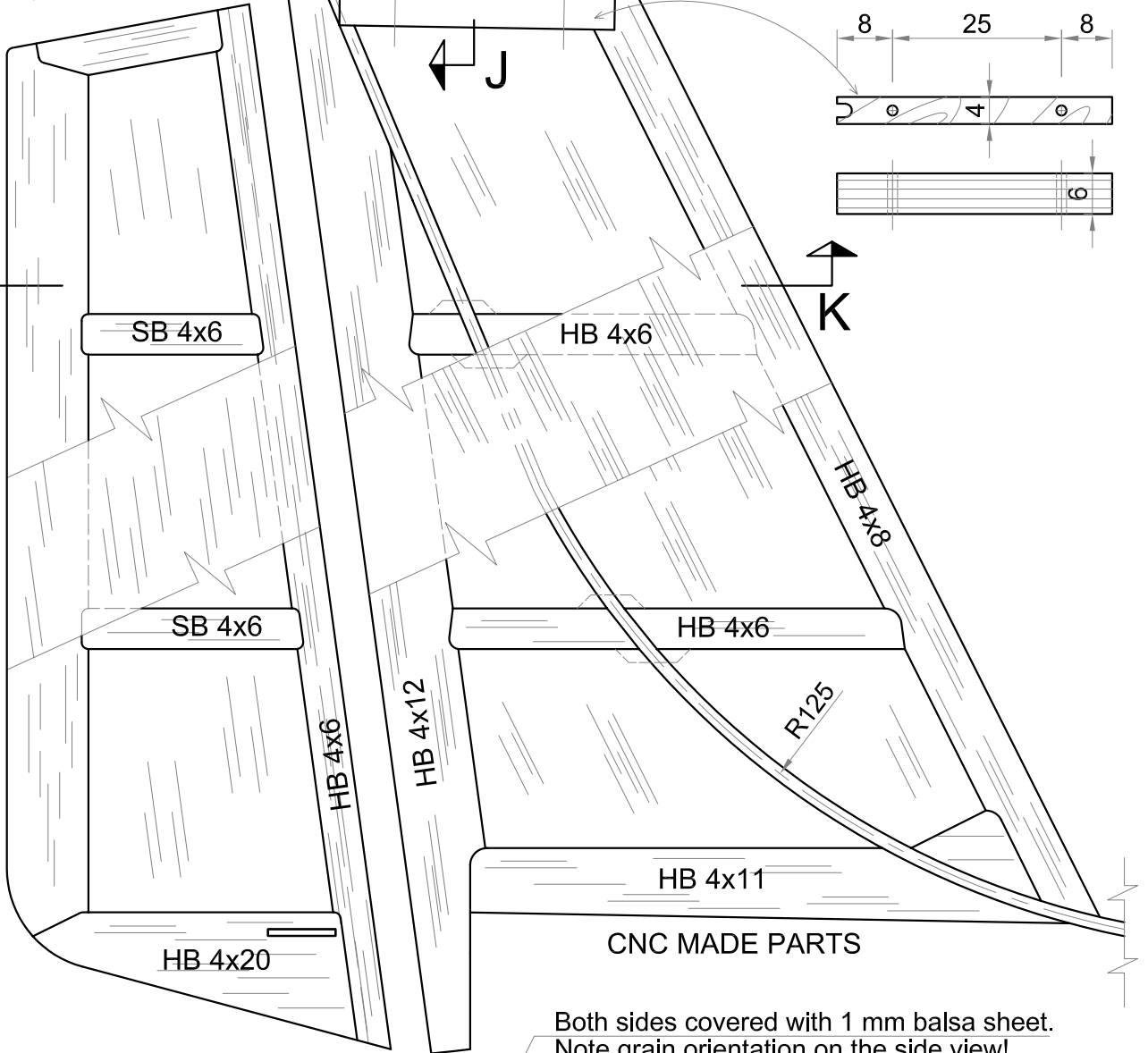

Both sides covered with 1 mm balsa sheet.
Note grain orientation on the side view!

1

Section K-K

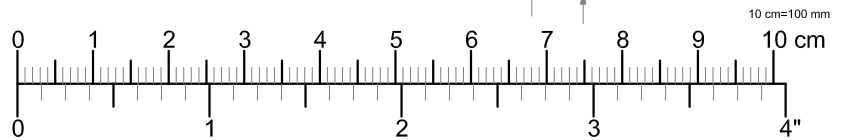

10 cm=100 mm

MATERIAL LEGEND:

- WP White Poplar
- Ply Plywood
- B Balsa wood
- SB Soft balsa wood
- HB Hard balsa wood
- SP Spruce wood
- PCB PCB composite material



MS-UL-Design

Model: **GUPPY MK II.** Full scale

Drawing: Vertical tail
10 Assembly drawing

Note: Plans for personal use only.
No commercial use allowed unless written permission from the author.

Designed by Ultralajt, jan.2009